

hySPAN LVL. Engineered like no other.





Engineered to perform. hySPAN LVL (Laminated Veneer Lumber) is engineered to provide predictable performance in residential, commercial, rural and industrial construction applications. It has been proven in the building market since it was first manufactured in Australia over two decades ago. Popular uses include rafters, floor joists, beams and lintels.

- Straight and true sections
- Consistent, predictable performance
- Long continuous lengths available
- Available termite protected (H2-S)
- Produced in Australasia by Carter Holt Harvey
- Product certified by the EWPAA - your guarantee of quality
- Ultra low formaldehyde levels (E<sub>0</sub>)
- Manufactured from responsible and sustainably managed plantation timber





### Wood, naturally.

Wood is one of the world's most environmentally friendly building products. It is natural, renewable, biodegradable and overall sustainable.

Australia's leading timber and engineered wood products supplier, Carter Holt Harvey, is committed to conserving and protecting the Australian natural environment. Carter Holt Harvey adheres to:

- Certified environmental standards
- Reducing water usage
- Using resources efficiently

Carter Holt Harvey ensures that all its wood is legally sourced from sustainably managed, plantation pine forests, by way of third party audit and 'chain of custody' requirements and does not source wood from genetically modified or 'old growth' sources.

Wood products require less energy to produce than almost any other building product. Much of the energy used in the processing of timber is derived from the combustion of process residues as biofuel, making wood essentially greenhouse gas neutral when compared with fossil fuels.

Timber is the only building product that is a natural carbon store and plays a major role in combating climate change.

Choosing products by Carter Holt Harvey, which are sourced from sustainably managed plantation forests, stimulates the expansion of Australia's plantation forest estate, representing a permanent long-term decrease in Australia's greenhouse gas emissions.

Carter Holt Harvey – using wood, naturally for a responsible and sustainable business. Visit [www.chhwoodproducts.com.au](http://www.chhwoodproducts.com.au) for further information on our environmental initiatives.



The mark of responsible forestry

SCS COC 001319

[www.fsc.org](http://www.fsc.org)

© 1996 Forest Stewardship Council

<sup>†</sup>Carter Holt Harvey Woodproducts is a supplier of FSC certified products. FSC available on request.

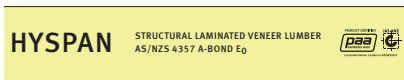
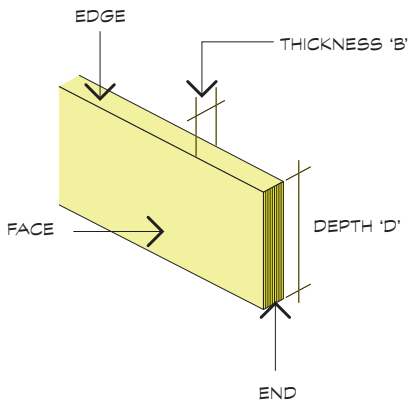

## Product Description

hySPAN® is structural laminated veneer lumber (LVL) which has been manufactured in accordance with AS/NZS 4357. hySPAN is manufactured in Australasia from renewable plantation timber which is rotary peeled, dried, and laminated together in continuous long lengths. The veneers are bonded together using a Type 'A' (marine) bond which has proven performance for in excess of 50 years. hySPAN is produced with a minimum grade 'D' face and is not generally used for appearance applications.

## Properties and Identification

The properties of hySPAN have been determined by testing as required by AS/NZS 4357, and are not substitutable for F grades, MGP grades, or any other proprietary LVL. The free designIT® software or span tables can be used to specify hySPAN beam sizes for houses or similar structures. Alternatively, properties for design to AS1720.1 are available in the hySPAN 'Limit States Design' brochure.

hySPAN is branded for ease of identification and evidence of compliance. Order it by name and look for the brand to confirm your specification and ensure your guarantee of quality.



## Engineered Wood Products Association of Australasia

hySPAN is product certified by the Engineered Wood Products Association of Australasia (EWPA), which is JAS-ANZ accredited. Participation and compliance with this process based quality control scheme gives peace of mind to the specifier and ensures 'Evidence of Suitability' in accordance with the BCA.

## Structural Reliability

hySPAN is manufactured by laminating various grades of veneer in a predetermined pattern in order to impart predictable and reliable structural properties. The uniformity of hySPAN is the key to its high strength and stiffness properties, giving specifiers and builders the confidence of meeting customer expectations.

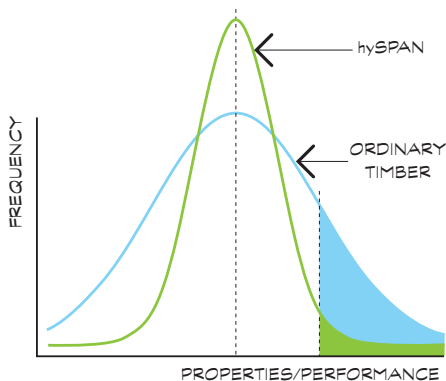

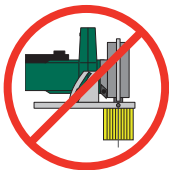

DO NOT RIP THROUGH THE DEPTH

Fixing of hySPAN

hySPAN may be installed and fixed in exactly the same way as seasoned timber. AS1684 contains many standard details for fixing of timber members which can be used as required. In order to determine the capacity of any fasteners used with hySPAN, joint group JD4 properties shall be taken to apply.

Modification of hySPAN sections

Rip Sawing hySPAN

hySPAN may be ripped through the thickness to achieve smaller section sizes without affecting the basic structural properties. Rip sawing through the depth however may adversely affect the strength properties and is therefore **not** recommended.

Holes, Cuts, Notches

AS1684 provides generic rules for these type of modifications of seasoned timber sections which can equally be applied to hySPAN members.

Section Lamination

Where multiple sections of hySPAN have been specified these should be securely laminated using the details provided. The use of Elastomeric adhesive is recommended to limit the entry of moisture between the laminates during construction.

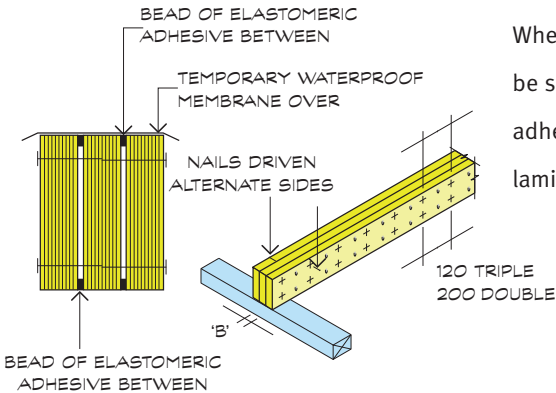

SECTION SIZE "B"	MINIMUM NAIL DIA	MINIMUM NAIL LENGTH
36	3.06 mm	75 mm
45	3.30 mm	90 mm
63	3.30 mm	100 mm

Vertical Lamination Detail

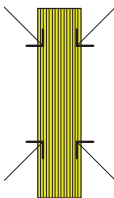

hySPAN TERMITICIDE IS 'LOCKED-UP' IN MANUFACTURE

Termite Protected

As part of the Carter Holt Harvey Deter-Ant® range all hySPAN sections are available H2-S treated against termites for use south of the Tropic of Capricorn. The treatment is applied to the glueline during manufacture to achieve full termite protection to the core of the beam. No further sealing is required on cut ends, holes, or notches. Other treatment levels may be obtainable from suppliers by request.



### Free designIT software

Simple to use yet deceptively powerful, designIT brings efficient and appropriate engineering design solutions within everyone's grasp.

Features include:

- Ability to design a wide variety of common structural beams
- Familiar building concepts and terms used
- Floor joist and bearer calculators to accurately design complex loads
- Provision of Design Certificates for members sized through the program
- Automatic update feature
- Technical literature in pdf format
- Common installation details

Contact Carter Holt Harvey for your free copy. Then simply update automatically using the "Check for updates" feature.

### Standard hySPAN sections and their approximate mass

90 x 42	2.4 kg/m	-	-	90 x 63	3.5 kg/m	-	-
95 x 36	2.1	95 x 45	2.7 kg/m	95 x 63	3.7	-	-
130 x 36	2.9	130 x 45	3.6	130 x 63	5.1	-	-
150 x 36	3.3	150 x 45	4.2	150 x 63	5.9	150 x 75	7.0 kg/m
170 x 36	3.8	170 x 45	4.7	170 x 63	6.6	-	-
200 x 36	4.5	200 x 45	5.6	200 x 63	7.8	-	-
240 x 36	5.4	240 x 45	6.7	240 x 63	9.4	-	-
-	-	300 x 45	8.4	300 x 63	11.7	300 x 75	14.0
-	-	360 x 45	10.0	360 x 63	14.1	-	-
-	-	400 x 45	11.2	400 x 63	15.6	400 x 75	18.6
-	-	-	-	450 x 63	17.6	-	-
-	-	-	-	-	-	525 x 75	24.4
-	-	-	-	600 x 63	23.4	600 x 75	27.9

All sizes available in lengths to 13.2 metres, longer lengths and other sizes available subject to enquiry.

Available From:

22 Prospect Street  
PO Box 425  
Box Hill Victoria 3128  
Australia

**General Enquiries**  
Freecall 1800 284 792  
Facsimile (08) 8739 7313

**Technical Enquiries**  
Freecall 1800 808 131  
Telephone (03) 9543 3733  
Facsimile (03) 9543 3766

[www.chhwoodproducts.com.au](http://www.chhwoodproducts.com.au)

 **CarterHoltHarvey**  
Woodproducts Australia